

Glass facade to match with existing Leisure Island Building

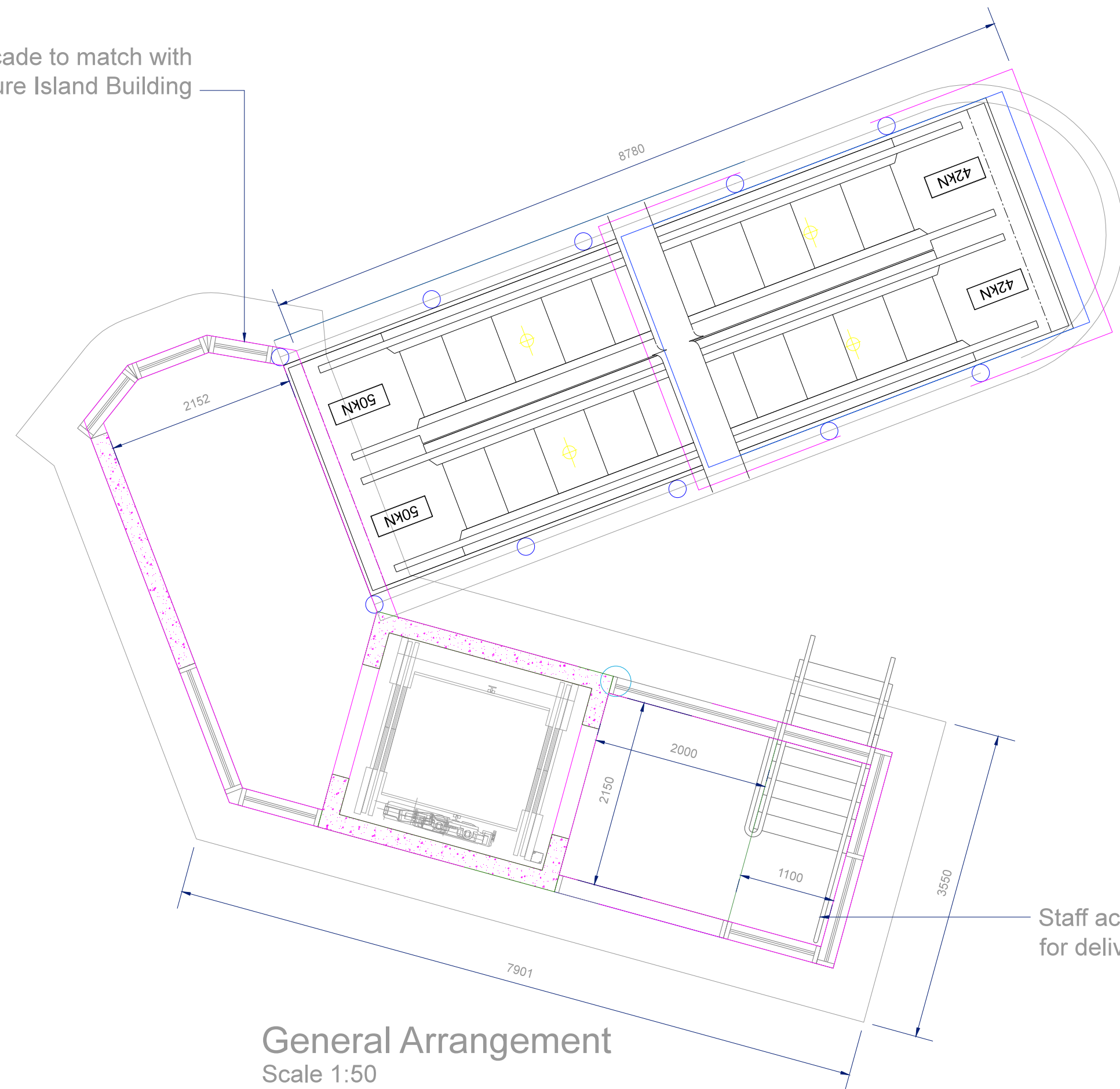

General Arrangement  
Scale 1:50

Staff access stairs for deliveries.

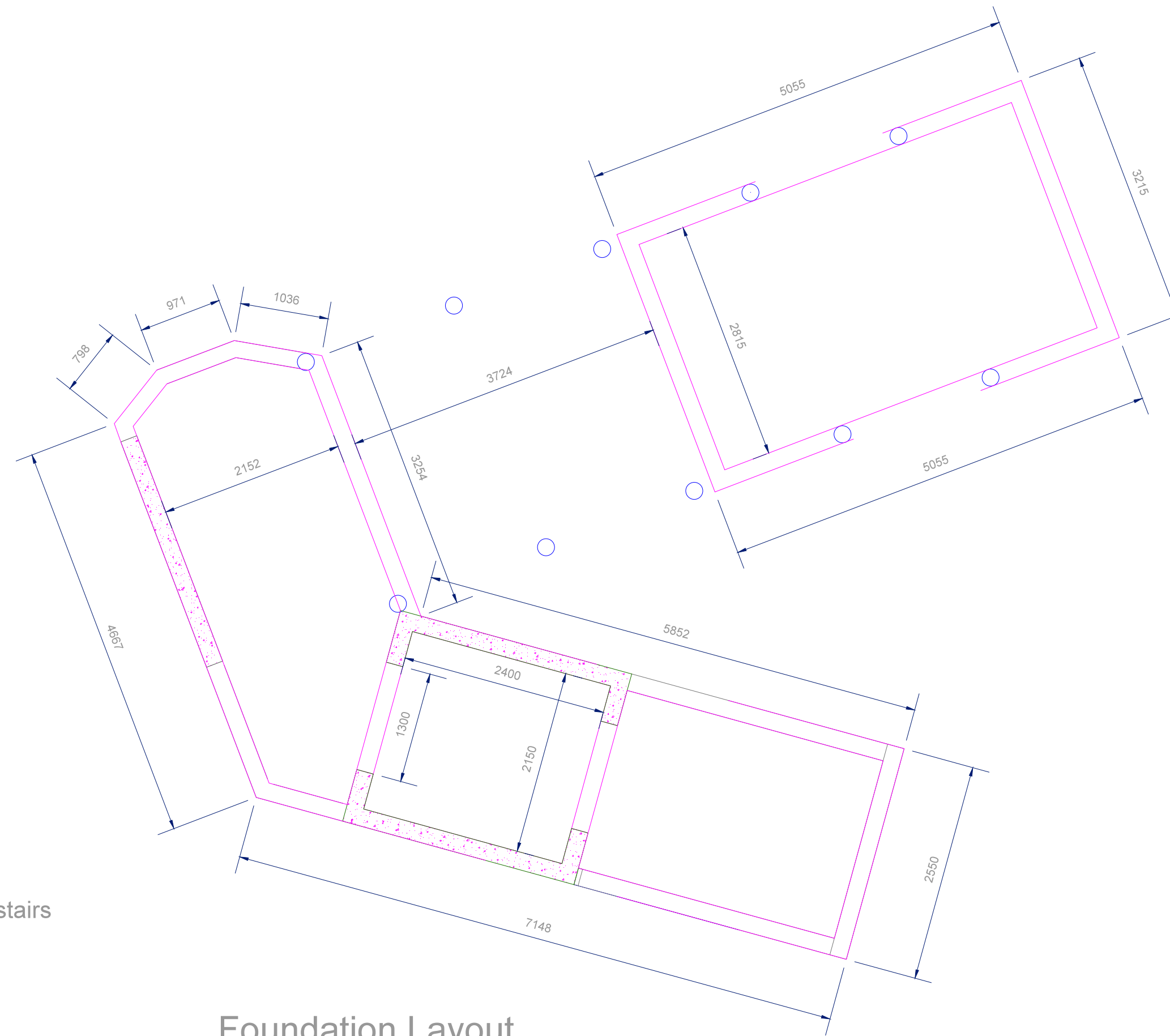

Foundation Layout  
Scale 1:50

External escalator for 5 star access customer access to Sunborn Vessel

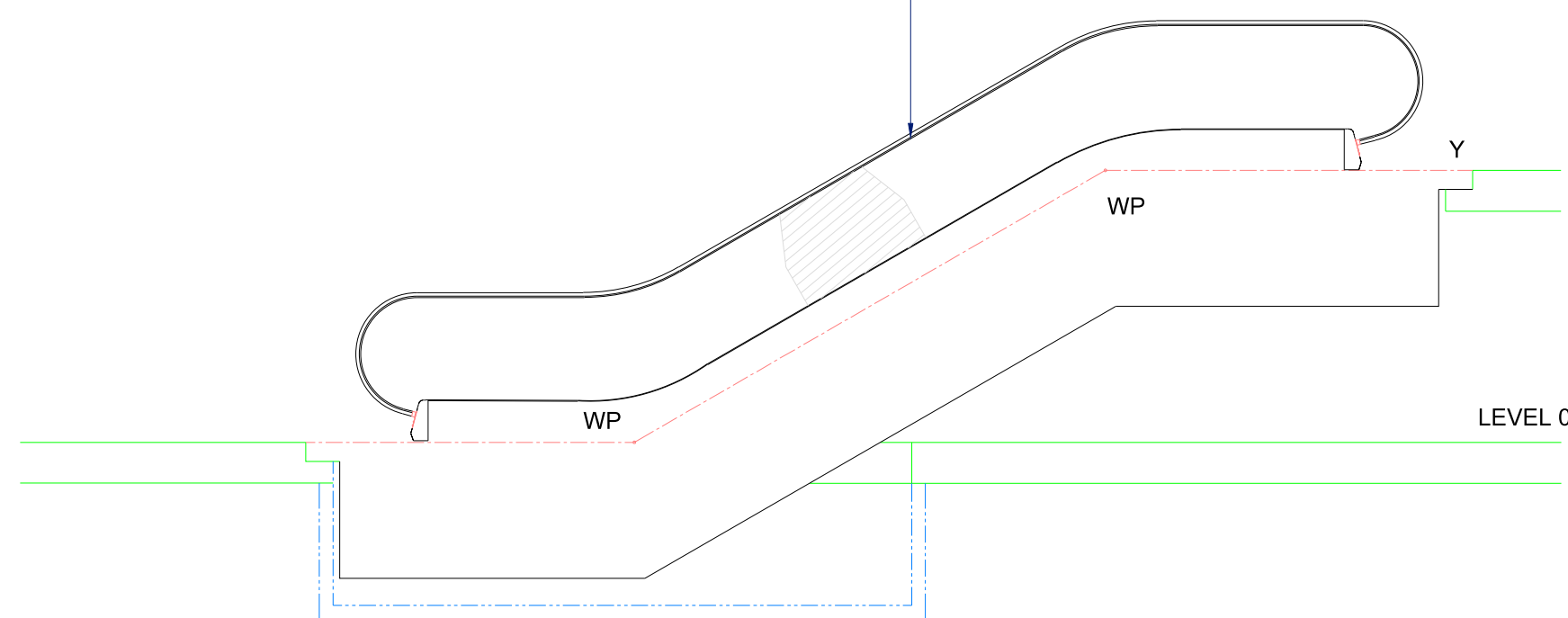

Escalator Elevation  
Scale 1:50

Stainless steel finish with fully enclosed side panelling

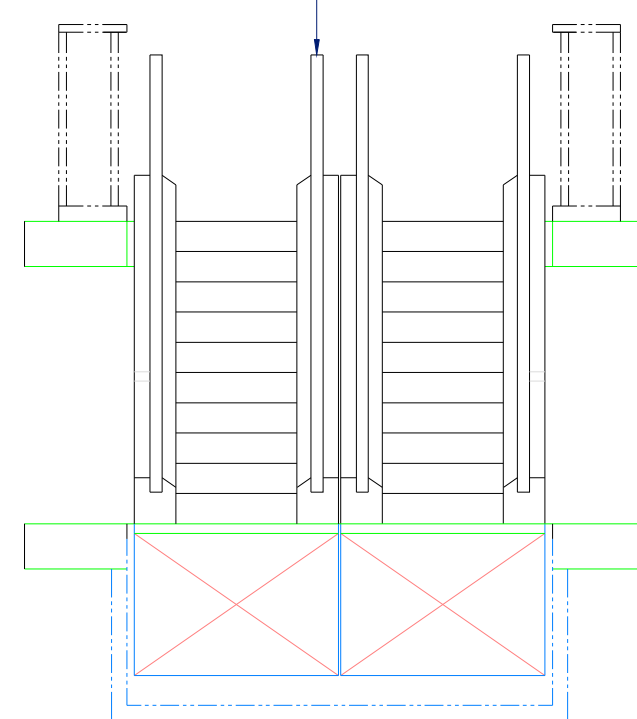

Escalator Elevation  
Scale 1:50

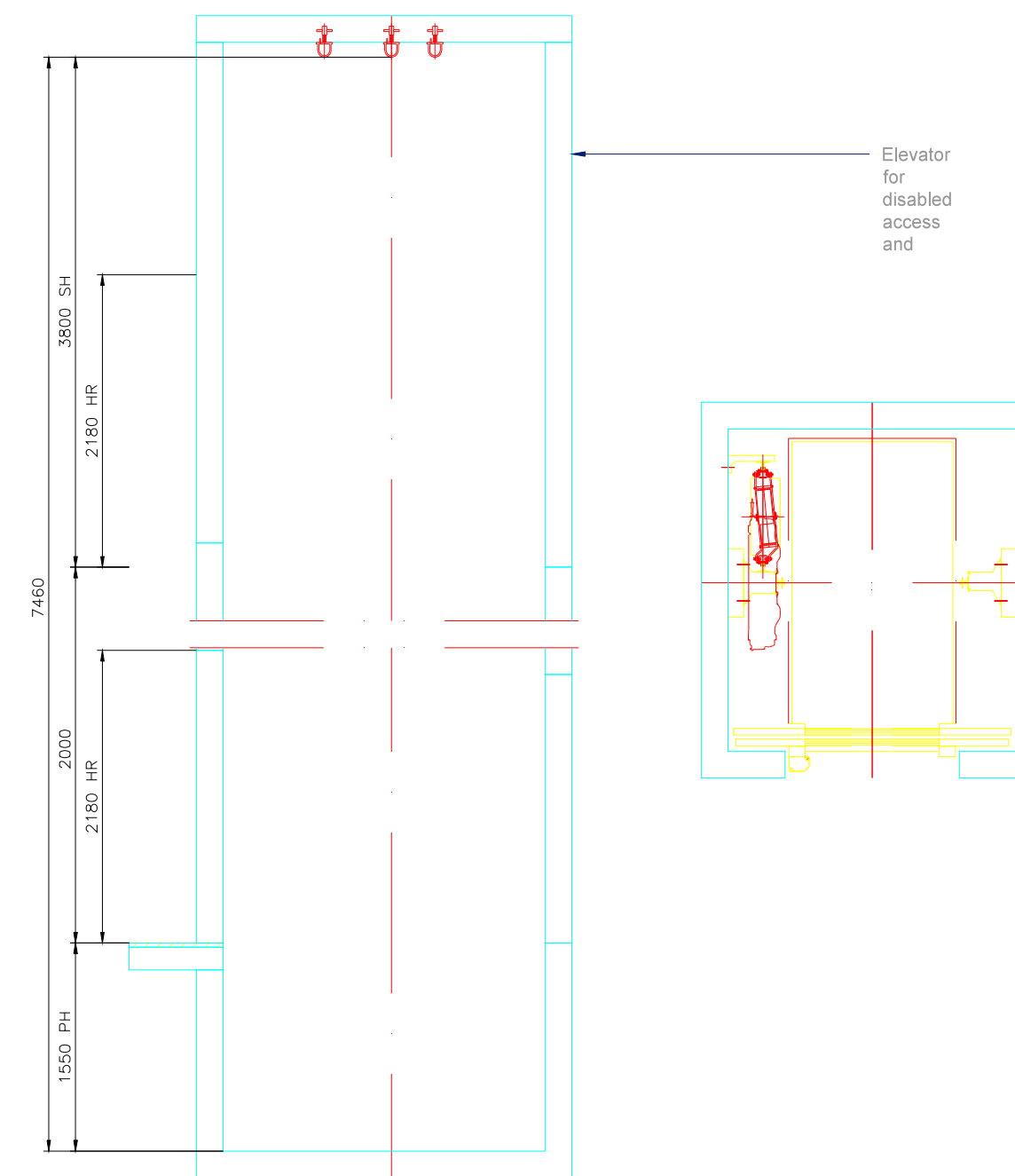

Elevator Section  
Scale 1:50

Elevator Plan  
Scale 1:50

**NSO Studio**  
ARCHITECTURE AND DESIGN

Tel: +34 663881236  
www.nomadstudioone.com  
info@nomadstudioone.com

Nomad Studio One SL.  
Calle de Pablo Casals 10,  
Bahía Dorada 2, Estepona,  
29680

Supporting & contributing to  
FSC Wood products  
Timber Trade Federation  
Joining us up for good

Drawing Name: <b>Overview of Basic Infrastructure</b> Sunborn Location		
Project Name: Sunborn Floating Hotel Ocean Village, Gibraltar		
Client Name: Ocean Village Investments Ltd Ocean Village, Gibraltar		
Drawn by: Shawn Sullivan	Date: 25 March 2013	Drawn by: 
Checked by: Shawn Sullivan	Level / Revision Date: None	Checked by: 
Drawing Reference: NSO-1500-015-00		